

Safe Load Tables

SECTIONAL PROPERTIES

	UNTOPPED	TOPPED
A	= 378.1 in ²	474.1 in ²
I	= 9185.0 in ⁴	12,890.8 in ⁴
Y _t	= 7.0 in	7.78 in
Y _b	= 7.0 in	8.22 in
St	= 1312 in ³	1,657 in ³
S _b	= 1312 in ³	1,568 in ³
bw	= 8.9 in	8.9 in
W _{gt}	= 98 psf	123 psf
v/s	= 3.1	
f' _{ci}	= 3500psi	f' _c = 6000psi
f' _{ct}	= 3000psi	f _{pu} = 270ksi



14" x 4'-0" HOLLOWCORE SLAB

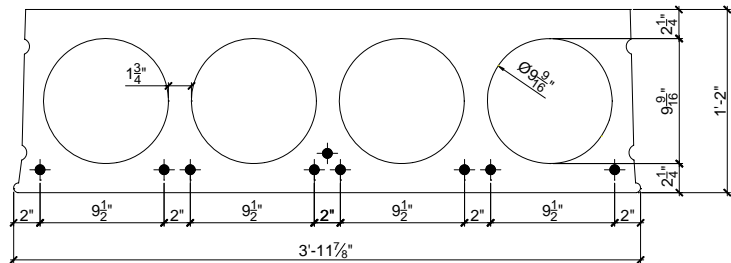

14" HC (UNTOPPED)

SPAN (FT)

STRAND DESIGNATION CODE	40	41	42	43	44	45	46	47	48	49	50	51	52	53	54	55	56	57	58	59	60	
88-S	120 0.5 0.5	110 0.5 0.4	100 0.4 0.3	92 0.4 0.2	84 0.3 0.1	76 0.2 -0.0	69 0.1 -0.2	62 0.0 -0.3	56 -0.1 -0.5	50 -0.2 -0.7	45 -0.3 -0.9	39 -0.5 -1.2	35 -0.6 -1.4	30 -0.8 -1.7								
108-S	148 0.9 0.9	138 0.8 0.9	129 0.8 0.8	121 0.8 0.7	113 0.7 0.7	106 0.7 0.5	99 0.6 0.4	92 0.5 0.3	85 0.4 0.1	78 0.3 -0.0	72 0.2 -0.2	65 0.1 -0.4	59 -0.0 -0.7	54 -0.4 -0.9	49 -0.4 -1.2	44 -0.5 -1.5						
128-S	171 1.2 1.5	161 1.2 1.4	151 1.2 1.4	141 1.2 1.3	133 1.2 1.3	124 1.1 1.2	117 1.1 1.1	109 1.0 1.0	102 0.9 0.7	96 0.8 0.6	90 0.7 0.4	84 0.6 0.4	78 0.6 0.2	73 0.5 -0.0	68 0.3 -0.3	63 0.2 -0.5	59 0.0 -0.8	56 -0.2 -1.1	51 -0.4 -1.4			
148-S	191 1.6 2.0	180 1.7 2.0	169 1.7 2.0	159 1.7 2.0	150 1.7 2.0	142 1.7 1.9	134 1.6 1.9	126 1.6 1.8	119 1.6 1.7	112 1.5 1.6	106 1.5 1.5	100 1.4 1.3	94 1.3 1.2	88 1.2 1.0	83 1.1 0.8	77 1.0 0.6	72 0.8 0.3	68 0.7 0.1	63 0.5 -0.2	59 0.4 -0.5	55 0.2 -0.9	

14" HC (TOPPED)

SPAN (FT)

STRAND DESIGNATION CODE	40	41	42	43	44	45	46	47	48	49	50	51	52	53	54	55	56	57	58	59	60
88-S	123 0.5 0.2	112 0.5 0.1	101 0.4 0.0	92 0.4 -0.1	83 0.3 -0.2	74 0.2 -0.4	66 0.1 -0.5	59 0.0 -0.7	52 -0.1 -0.9	45 -0.2 -1.1	39 -0.3 -1.4	33 -0.5 -1.6									
108-S	162 0.9 0.6	151 0.8 0.6	140 0.8 0.5	130 0.8 0.4	121 0.7 0.3	111 0.7 0.1	101 0.6 -0.0	92 0.5 -0.2	84 0.4 -0.3	76 0.3 -0.5	69 0.2 -0.7	62 0.1 -1.0	55 -0.0 -1.2	49 -0.2 -1.5							
128-S	191 1.2 1.1	178 1.2 1.0	166 1.2 1.0	155 1.2 0.9	144 1.2 0.8	134 1.1 0.7	125 1.1 0.6	116 1.0 0.5	108 0.9 0.3	100 0.8 0.2	93 0.7 -0.0	86 0.6 -0.2	80 0.5 -0.4	73 0.3 -0.7	69 0.2 -1.0	63 0.2 -1.2	57 0.0 -1.6				
148-S	212 1.6 1.6	202 1.7 1.6	190 1.7 1.5	178 1.7 1.5	167 1.7 1.4	157 1.7 1.4	147 1.6 1.3	138 1.6 1.2	130 1.6 1.1	121 1.5 0.9	113 1.5 0.8	105 1.4 0.6	98 1.3 0.4	91 1.2 0.2	85 1.1 -0.0	78 1.0 -0.3	73 0.8 -0.5	67 0.7 -0.8	62 0.5 -1.2	57 0.4 -1.5	

NOTES:

1. Loads indicated are totals superimposed service loads in lbs/ft².
2. Design confirms with ACI-318-99 and CSA 23.3-94.
3. For higher loads than indicated - contact manufacturer.
4. Live load deflection is less than L/360.
5. The camber values provided are only estimated and should not be used as absolute values. Always contact manufacturer, if camber is a concern.